

PLASTIVAN INSTALLATION GUIDE

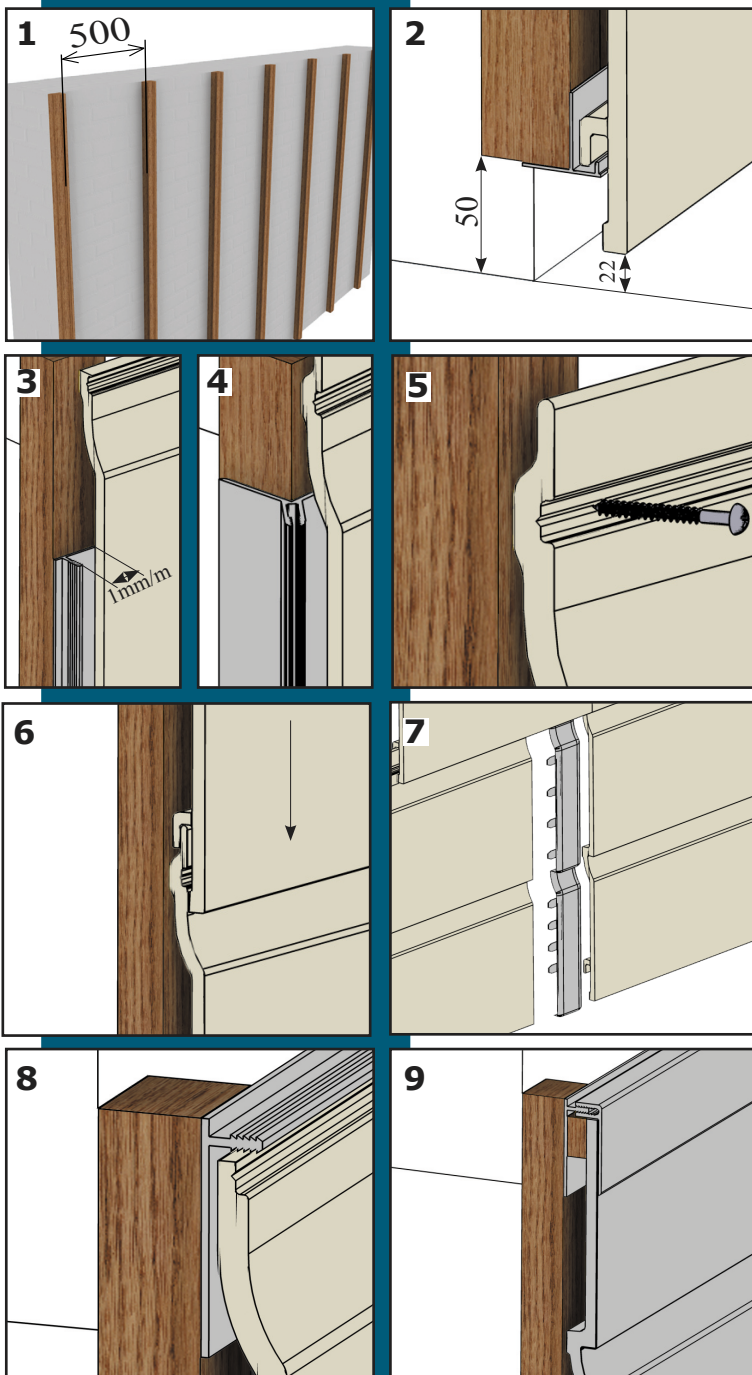
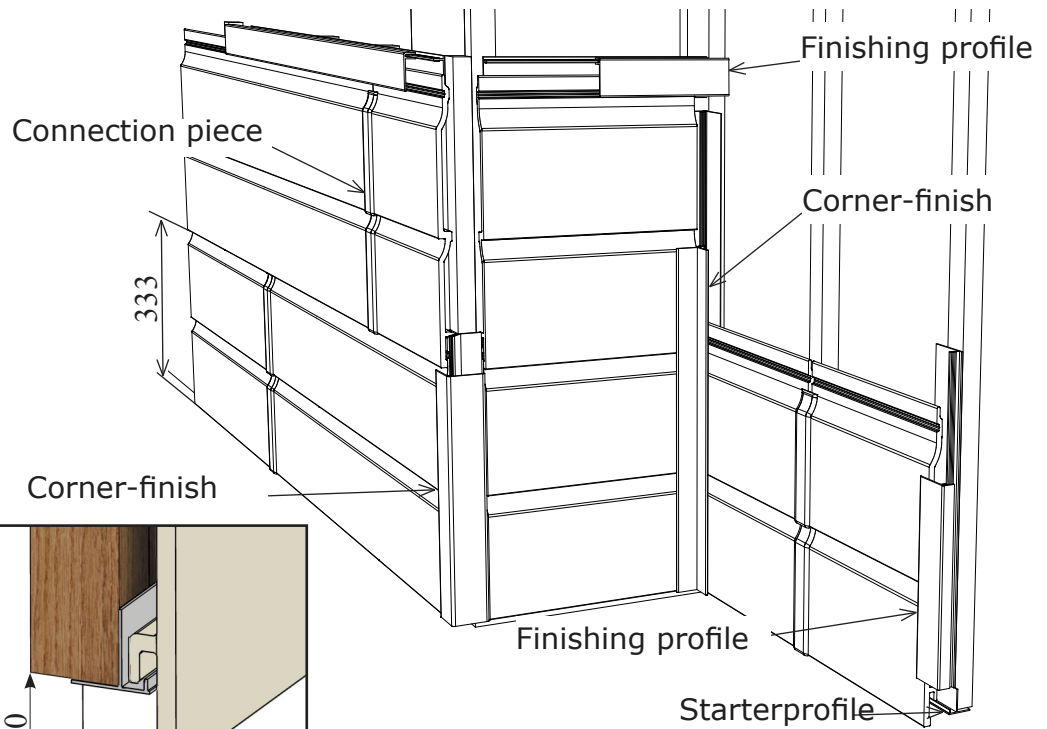

Preperations

The wooden battens (1) serve as a base for installing the Durasid cladding and siding, battens need to be treated timber and a minimum 22 x 30mm.

A vapour barrier between the wall and battens must be installed battens should be vertically fixed at maximum centres of 500mm.

Installing

The starter profile (2) is fixed to the bottom of the battens (ensure level by use of a spirit level).

Before installing the cladding the 2 part edge trims, back part (3) should be installed to all perimeters and including surrounds of windows and doors.

Internal or external corners (4) again fix the base profile prior to fixing the cladding. When fixing finishing profiles allow 1mm/Mtr expansion gap on either side of cladding.

Durasid panels are fixed (5) either with 30mm stainless steel screws or 30mm stainless steel cladding nails.

After the first panel has been installed into the starter trim (6) subsequent panels are fitted ensuring that the tongue and groove joint is tightly closed.

Joining of panels (butt joint) is by the use of the appropriate embossed individual connection piece (7).

To finish, before fixing last panel first install the base of the finishing profile (8) if it is necessary to cut the last panel down, support by packing the back either by using the off cut or alternatively with a thin batten and secure through all with 30mm stainless steel screws or 30mm stainless steel cladding nails.

Conclude by securing all finishing profiles by fastening the front parts of the trim to the backs (9). A 100x50mm L-shaped profile can be used to finish any other corner or other application.